

机器人专用超薄伺服制动器

Ultra-thin brake for Robot

瑞迪机器人超薄伺服制动器采用定制化摩擦片技术，使得在保证扭矩的前提下，厚度只有普通制动器的1/2，同时与专用控制器（也可自行配置）配套使用，耗电量仅有普通制动器的1/3。得益于这种电路控制，普通发热量仅有普通制动器的1/2。

REACH ultra-thin servo brake for robots, adopts customized friction plate technology, so that the thickness of the brake is only 1/2 of the ordinary brake under the premise of ensuring the torque. At the same time, it is used together with the special controller (also self-configurable), and the power consumption is only 1/3 of the ordinary brake. Thanks to this kind of circuit control, the heat generation is only 1/2 of the ordinary brake.

控制时序图 Control Sequence Diagram

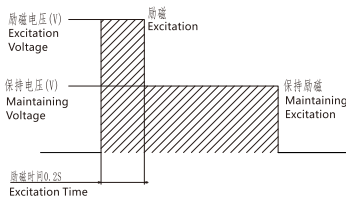

技术参数

Technical Data

型号 Model	静摩擦转矩 Ts [N·m]	线圈 (20℃时) Coil (at 20℃)								耐热等级 Heat Resistance	最高转速 Maximum speed of rotation [r/min]	转动惯量 Rotational inertia J[kg·m ²]	允许制动做功 Allowable energy braking E _{ba} [J]	总制动做功 Total acting energy E _T [J]	电枢吸引时间 Time of armature absorption (DC24V) t _a [s]	电枢释放时间 Time of armature absorption (DC7V) t _{ar} [s]	质量 Mass s[kg]
		过励磁输出 Over-excitation output				稳态励磁输出 Steady-state excitation output											
		电压 Voltage [V]	功率 Power [W]	电流 Current [A]	电阻 Resistance [Ω]	电压 Voltage [V]	功率 Power [W]	电流 Current [A]	电阻 Resistance [Ω]								
15LE	0.06	24	16.5	0.688	35	7	1.4	0.2	35	F	6000	5 × 10 ⁻⁸	5	1000	0.02	0.02	0.03
20LE	0.1	24	16.5	0.688	35	7	1.4	0.2	35	F	6000	8 × 10 ⁻⁸	15	3000	0.035	0.02	0.06
25LE	0.3	24	16.5	0.688	35	7	1.4	0.2	35	F	6000	3 × 10 ⁻⁷	15	3000	0.035	0.02	0.08
35LE	0.5	24	16.5	0.688	35	7	1.4	0.2	35	F	6000	7 × 10 ⁻⁷	90	18000	0.05	0.02	0.12
40LE	1.3	24	16.5	0.688	35	7	1.4	0.2	35	F	6000	2 × 10 ⁻⁶	90	18000	0.06	0.02	0.16
45LE	2	48	24	0.5	96	18	3.4	0.19	96	F	6000	3 × 10 ⁻⁶	200	40000	0.06	0.025	0.23
50LE	2	24	15	0.625	38.4	10	2.6	0.26	38.4	F	6000	4 × 10 ⁻⁶	150	30000	0.06	0.025	0.40
100LE	5	24	16.5	0.688	35	14	5.6	0.4	35	F	5000	2 × 10 ⁻⁵	500	100000	0.08	0.04	0.50

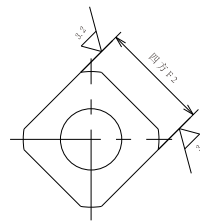
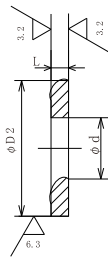
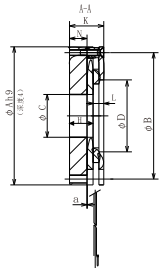
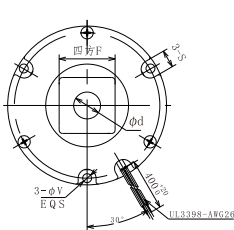

方形轮毂
客户可以参照上图尺寸自行加工或咨询我司

Square hub
The customer may refer to the sizes in the drawings

型号 Model	径向尺寸 Radial dimension [mm]								轴向尺寸 Axial dimensions [mm]					转子轭加工尺寸 Finish size of motor mulberry				
	A	B	C	D	dmax	F	S	V	H	K	N	a	L	D2	F2	dmax		
15LE	26	22	7	12	4	8	4.3	2.3	9.6-9.8	14	7	0.1	4 以上 Above4	10	8	4		
20LE	32	28	9	16	8	12	5.0	2.3	9.6-9.8	14	7	0.1	4 以上 Above4	14	12	7		
25LE	39	33	9	18	8	12	5.5	3	9.6-9.8	14	7	0.1	4 以上 Above4	14	12	7		
35LE	48	42	16	28	14	19	5.5	3	9.6-9.8	14	7	0.1	4 以上 Above4	23	19	14		
40LE	56	50	16	28	14	19	6.5	3.4	10-10.2	14.5	7.4	0.1	4 以上 Above4	23	19	14		
45LE	68	60	24	37	20	25	6.5	M3	11.6-11.8	16	8	0.1	4 以上 Above4	31	25	20		
50LE	71	65	21	37	20	25	8.0	3.4	13.1-13.3	18	9.5	0.1	4.5 以上 Above4.5	31	25	20		
100LE	83.5	76	47	47	28	35	9.0	4.5	17-17.4	25	14.7	0.1	5 以上 Above5	42	35	28		